



Williams Products, Inc

1750 Maplelawn

Troy, MI. 48084

Toll Free: 800-521-9594 Phone: 248-643-6400

Fax: 248-643-7117

Everlastic® MF-40 Ribbed Flashing

PRODUCT DESCRIPTION:

Everlastic® MF-40, A 40 mil self adhering membrane composed of 32 mils rubberized asphalt adhesive bonded to 8 mil polyethylene film.

Use:

Everlastic® MF-40 Ribbed is a tough, self-adhering, self-healing composite membrane masonry flashing. When in place the membrane provides a barrier against water, air and vapor diffusion. Mechanical fastening through membrane will not destroy integrity. Everlastic® MF-40 Ribbed Masonry Flashing complies with Volatile Organic Compound (VOC) regulations.

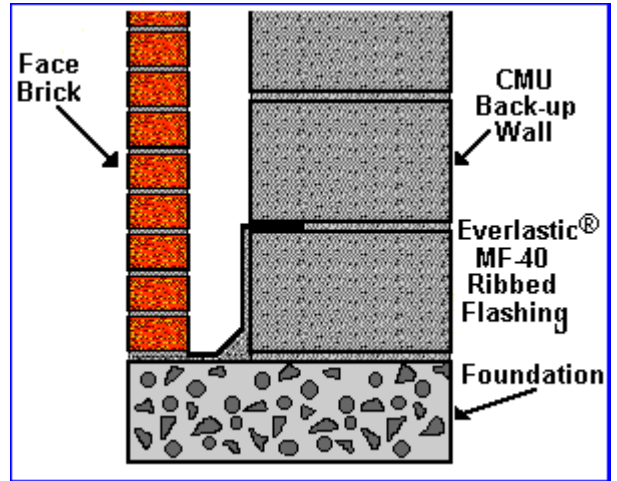

ADVANTAGES:

The Horizontal Ribbing of the MF-40 Ribbed assures that the material will not slump in the joint over time - slumping allows moisture to collect rather than exit the cavity wall. Flexibility and self-adhering nature of membrane allows for simple, positive and integral installation and field fabrication of splices, end dams, etc. Everlastic® MF-40 Ribbed Masonry Flashing provides a continuous bond to most substrates and is impervious to water and air penetration. The membrane does not age harden, remains flexible over wide temperature ranges and is able to bridge small cracks. Everlastic® MF-40 Ribbed is not effected by exposure to sunlight for up to 120 days after placement

LIMITATIONS:

Do not apply membrane in areas where it may be permanently exposed to the sunlight. Membrane is not compatible with fresh coal tar or coal tar pitch and sealant products containing polysulfide polymers. The use of thin-set tile systems with membrane is not recommended. Provide sound, clean and dry substrate for surfaces to receive membrane. Install when air and surface temperatures are 40°F and above.

COMPOSITION:

System: The masonry flashing membrane system consists of a membrane, adhesive and sealant. The membrane is a self-adhesive, cold-applied sheet composed of rubberized asphalt adhesive bonded to a polyethylene film. All end and side joints are sealed with a sealant.

Size: Everlastic® MF-40 Ribbed is supplied in 18-inch wide rolls in 75 foot lengths and packaged 2 rolls per carton. Release paper protects the adhesive side until use.

INSTALLATION:

General: Install Everlastic® MF-40 Ribbed membrane in masonry at shelf angles, lintels, ledges and other obstructions to the downward flow of water in the wall. Ensure masonry surfaces are smooth and free from

projections that could puncture membrane. Seal penetrations in membrane with adhesive and sealant. Prime substrate with MF-40 Ribbed Adhesive where existing conditions compromise membrane adhesion.

At cavity masonry walls: Extend membrane 1/2 inch back from exterior face of outer wythe of masonry through the outer wythe turned up a minimum 4 inches and tuck into bed joint of the inner wythe.

At masonry veneer walls: Extend membrane from exterior face of veneer through the veneer up face of sheathing at least 8 inches and behind barrier.

At lintels and shelf angles: Extend membrane a minimum of 4 inches into masonry at each end. At heads and sills extend membrane 4 inches at ends and turn up not less than 2 inches to form pan. Hold membrane back 1/2 inch from face. Use flashing drip to extend past face.

TYPICAL PHYSICAL PROPERTIES:

Property	ASTM Standard	Results
Color		Black
Thickness		.040"
Puncture Resistance	E 154	70.0 lbf
Tear Propagation Resistance	D 1938	10.0 lbf
Initial Tear Resistance	D 1004	11.0 lbf
Tensile Strength, Surface Film	D 412, Die C	3160 psi
Tensile Strength, Membrane	D 412, Die C	858 psi
Elongation to Failure of Rubberized Asphalt	D 412, Die C	495%
Pliability, 180° bend over 1" Mandrel	D 1970	-35°F
Lap Peel Adhesion at 25°F	D 1876	12 lbf/in width
Water Vapor Transmission	E 96	0.01 perms
Water Absorption	D 570	.56%
Crack Cycling, .0125" at -15°F	C 836	Pass



We do not guarantee the applicability or accuracy of this information or the suitability of our products for any given situation. The products discussed are sold without warranty, expressed or implied. Buyer assumes all responsibility for any loss or damage arising from the handling or use of our products, whether done in accordance with directions or not. Statements concerning the possible use of our products are not intended as recommendations to use our products in the infringement of any patent.